

NOTE: LETTERS IN BOX  AT LIGHT FIXTURE INDICATES TYPE OF FIXTURE - SEE SCHEDULE & CATALOGUE IN COMMUNITY BLDG. WIRING FILE

Note: Compressors for restaurant to be in basement here powered from circuit from Panel "C"

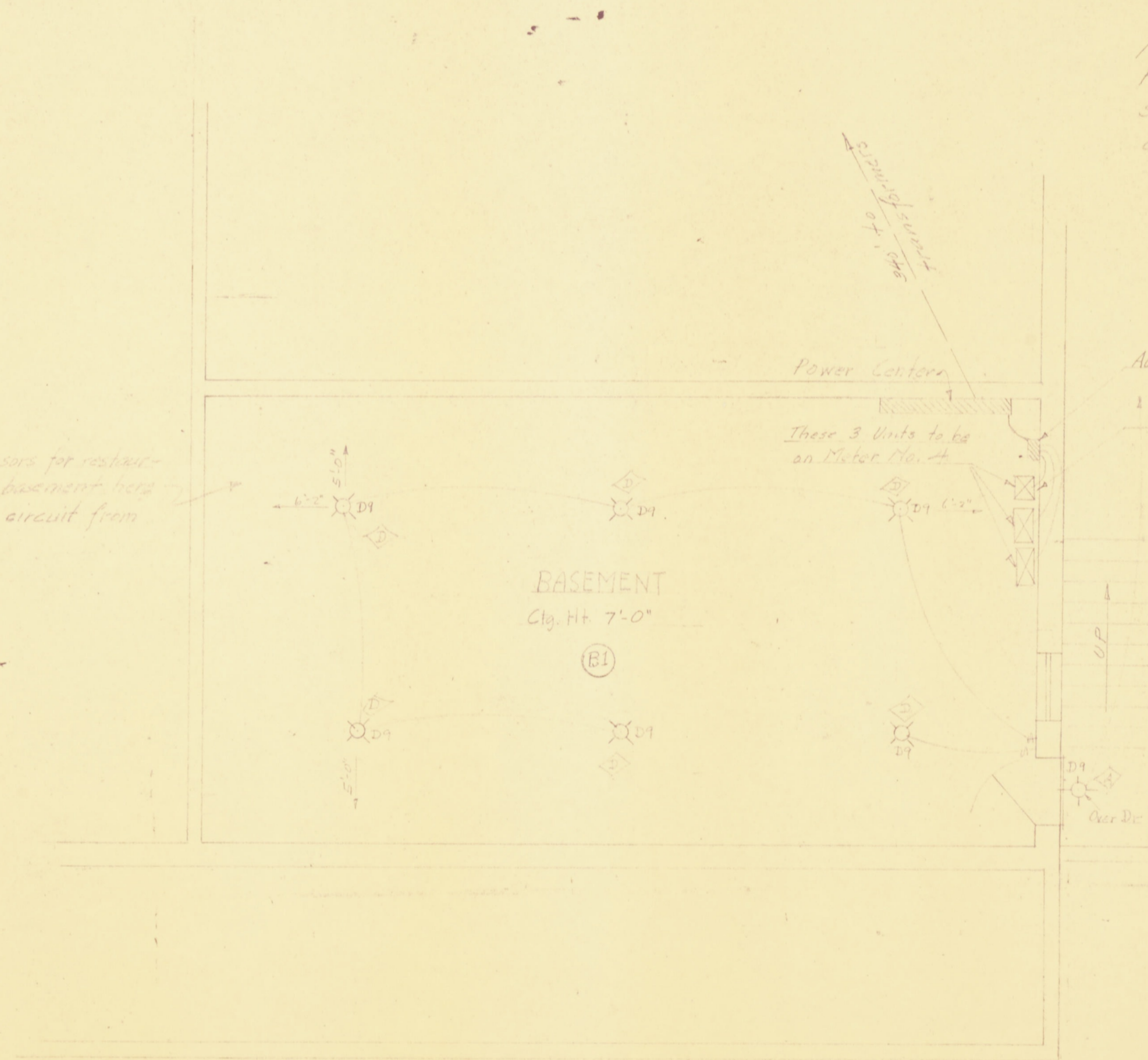

Aux Load Center for Compressors
 1 1/4 H.P.-110V-1Ph. Carbonator Comp.
 3/4 H.P.-220V-1Ph. Cooler Comp.
 1 H.P.-220V-1Ph.

INLAND STEEL COMPANY INCORPORATED WHEELWRIGHT, KENTUCKY.	
Community Building Basement Wiring & Lighting	
SCALE 1/4" = 1'	DATE 7/10/44
REVISED	
MADE BY	TRACED BY J. E. J.
APPROVED BY	
FILE NO.	27-F

8846 Wheelwright Collection
 Blueprints: 79, Inland Steel