

*Formica*

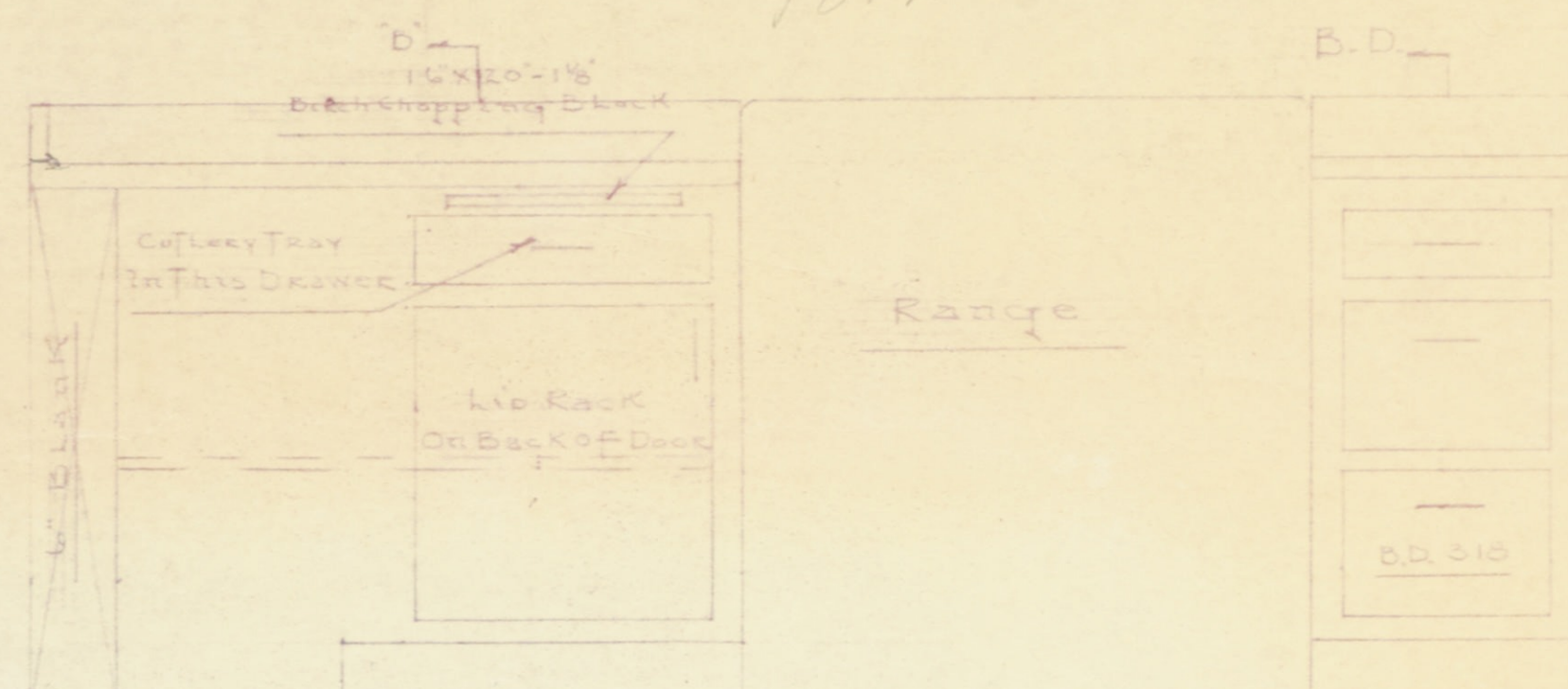

Elevation Cabinets Wall B

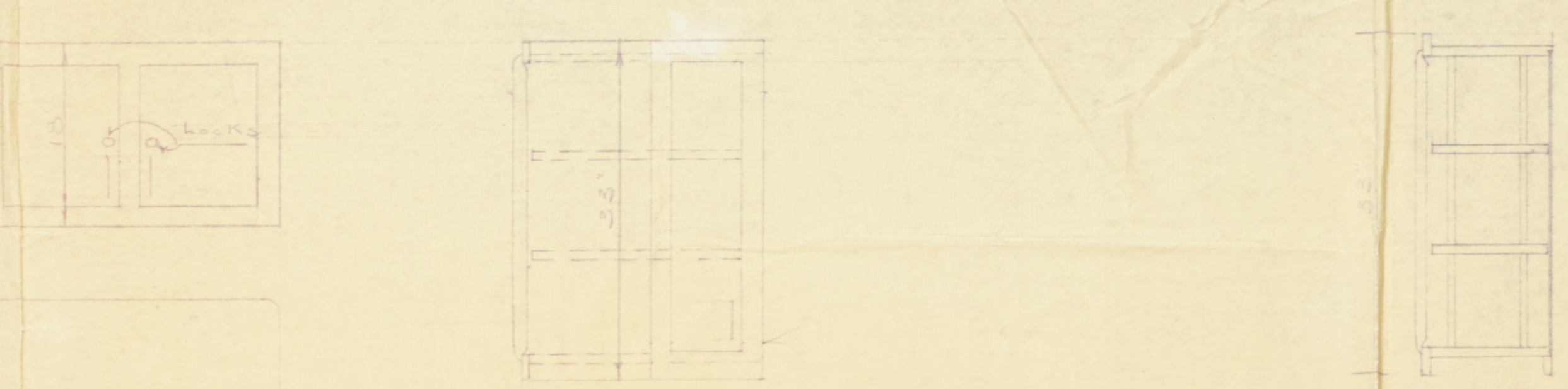

Elevation Cabinets Wall C

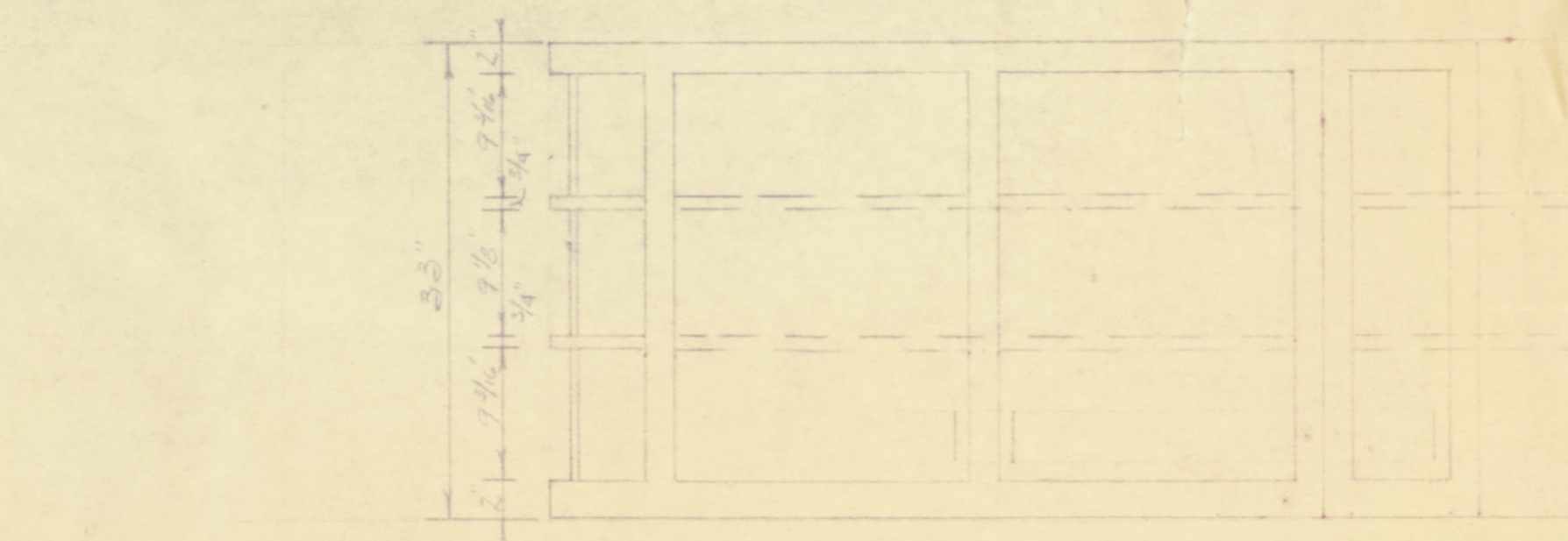

Elevation Cabinets Wall D

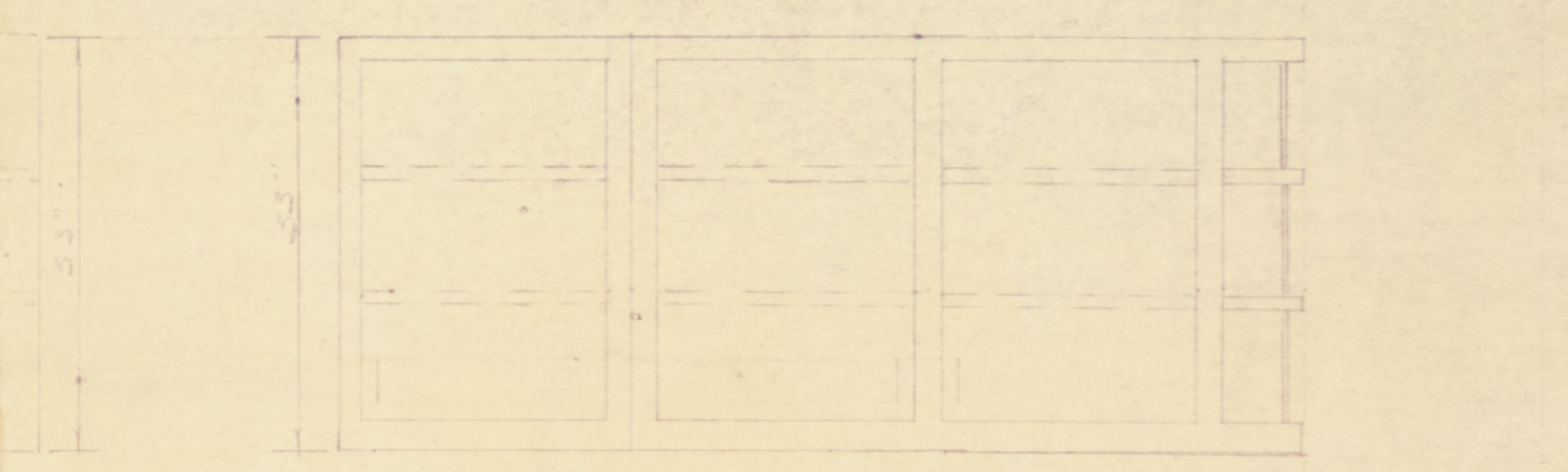

Elevation Cabinets Wall D Opposite Side

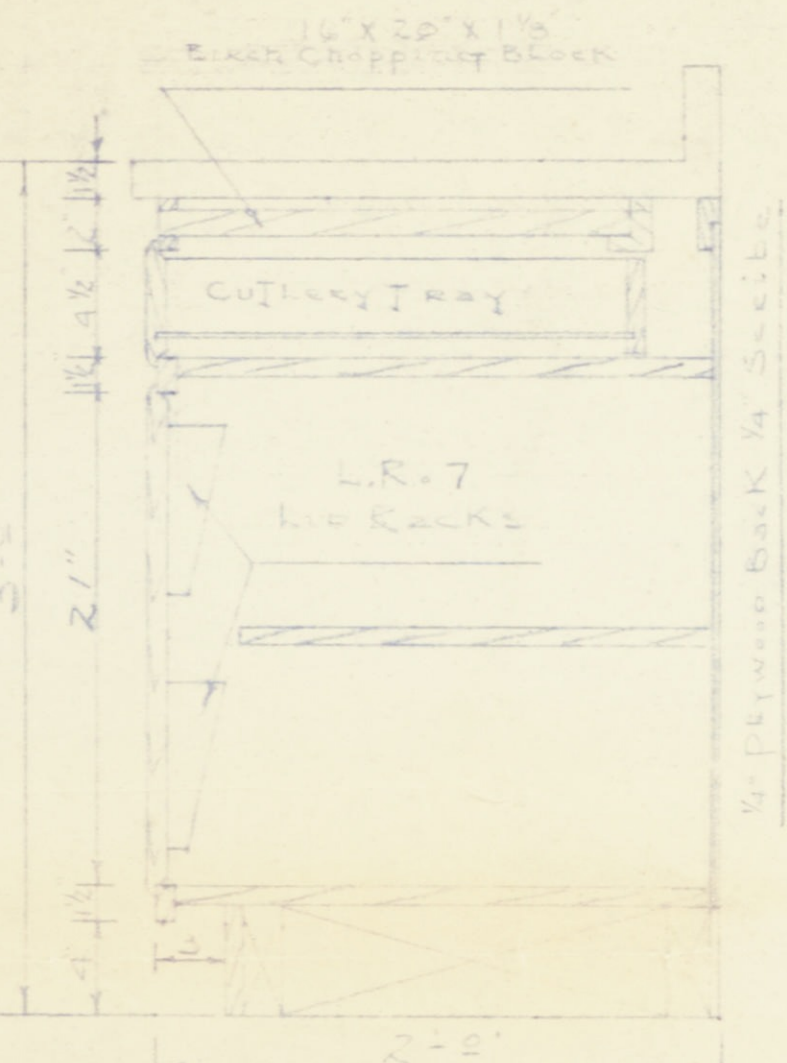

Typical Thru Section Wall B

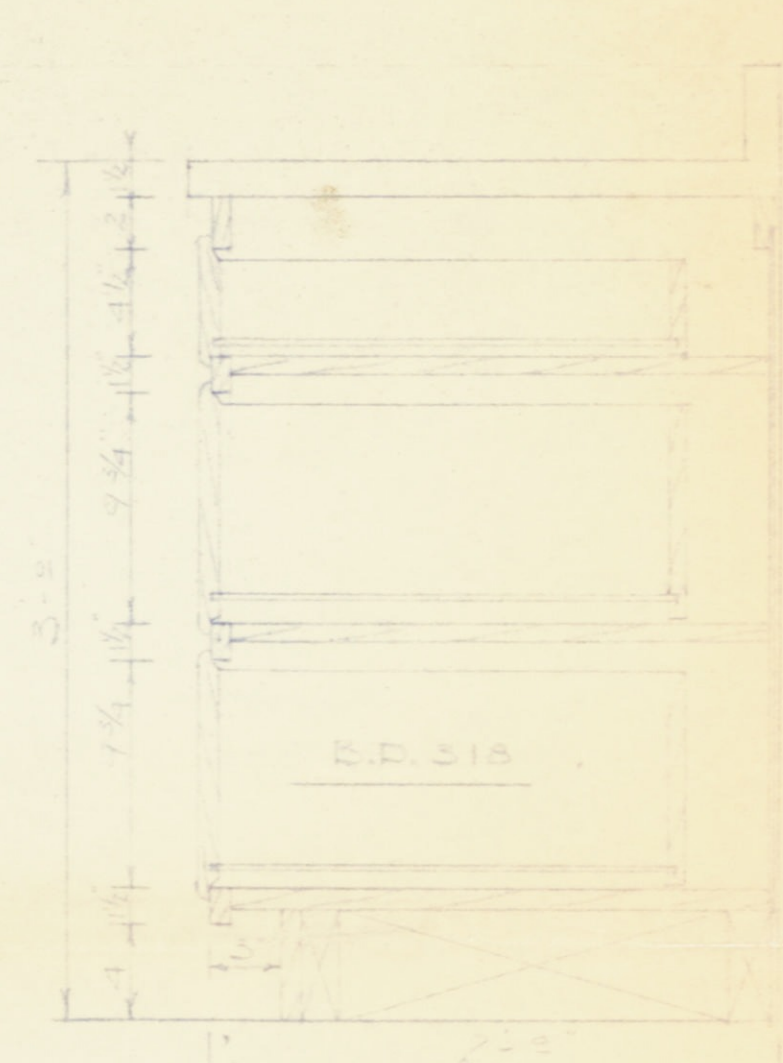

Typical Thru Section Wall B

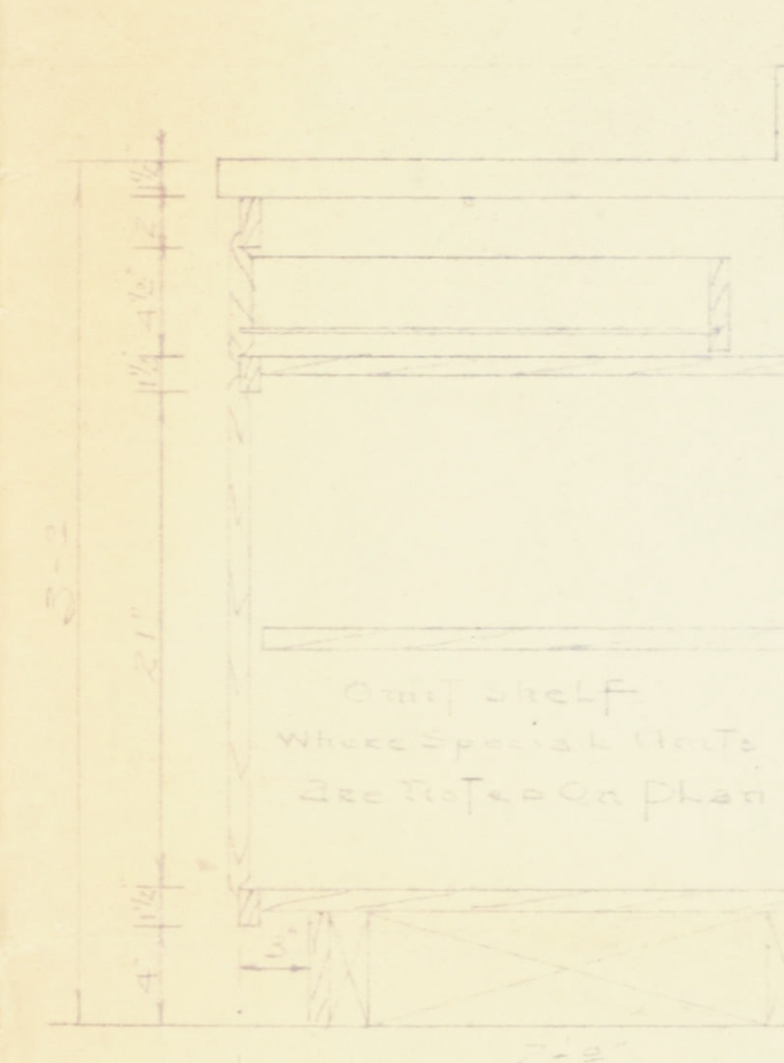

Typical Thru Section Sink Unit

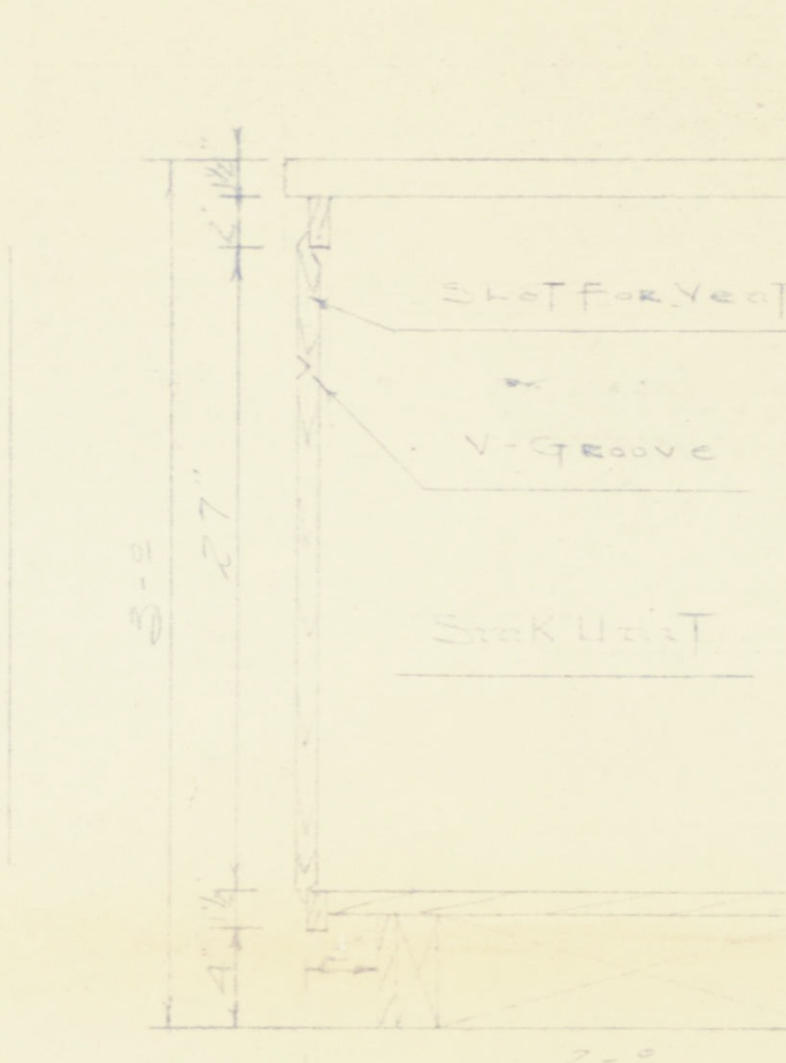

Typical Thru Section Wall D

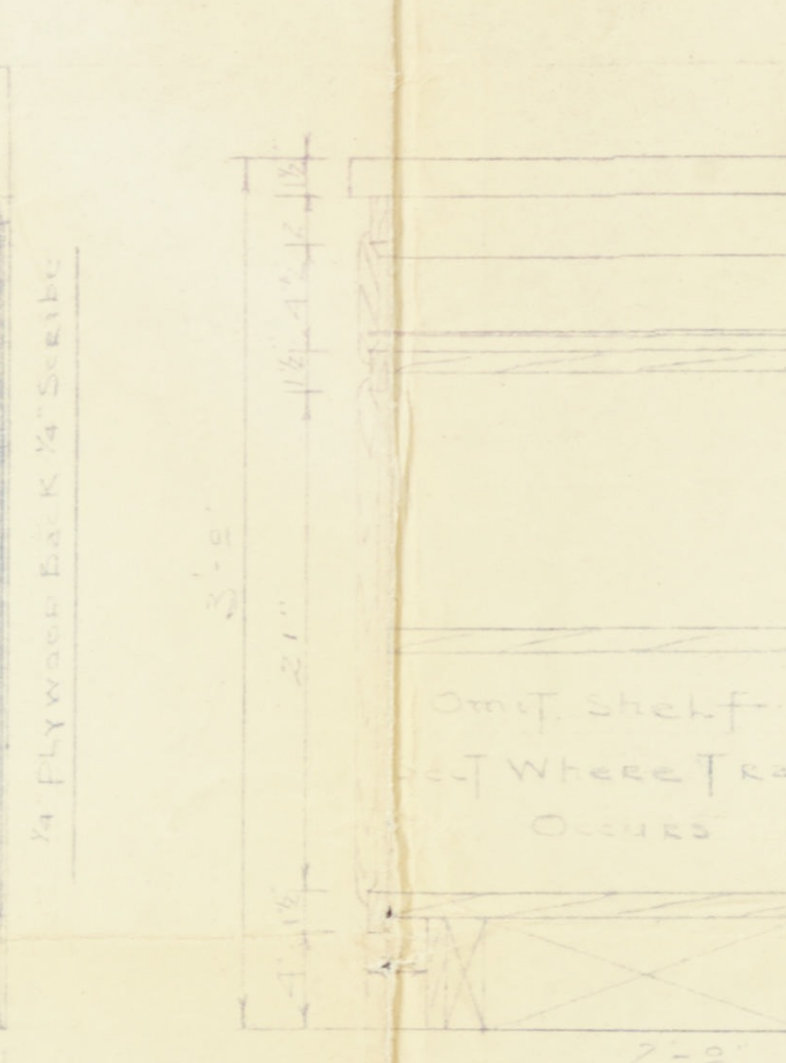

Typical Thru Section Wall D

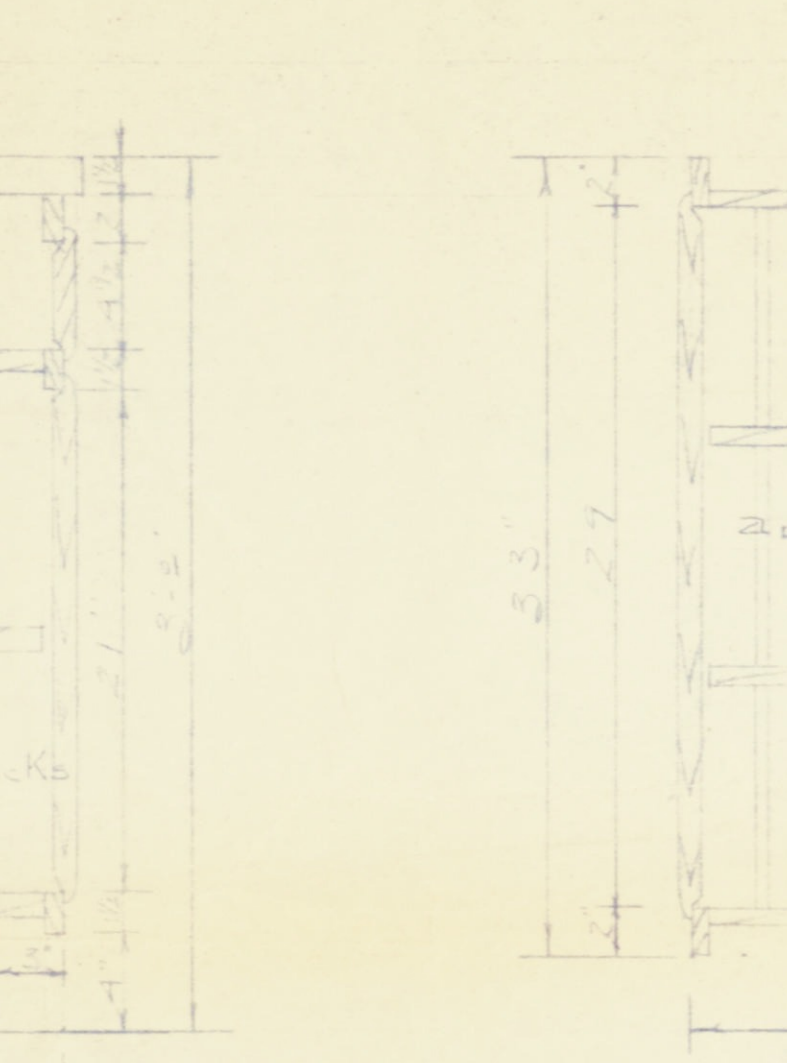

Typical Thru Section Wall D

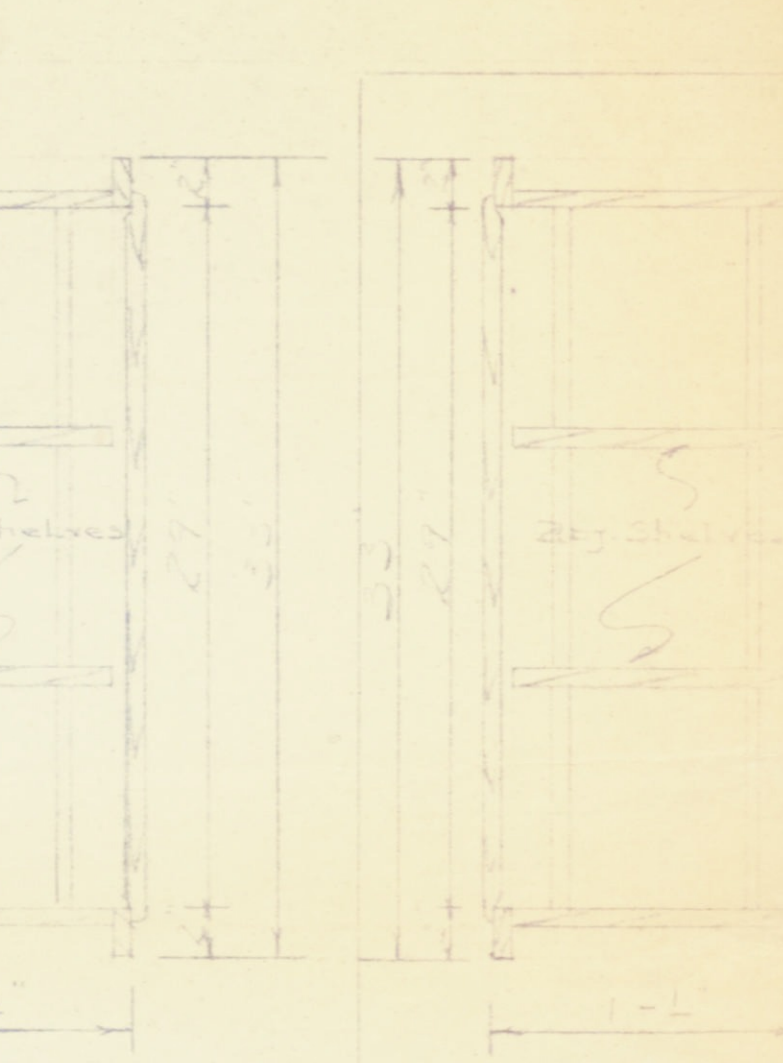

Typical Thru Section Wall D

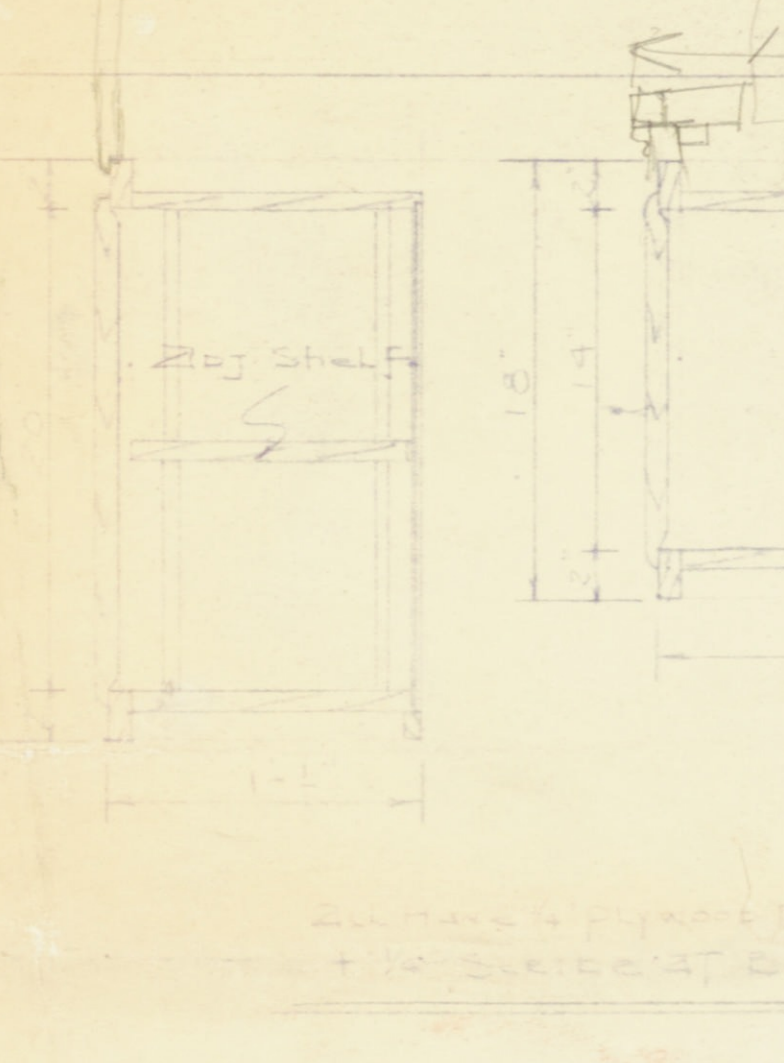

Typical Thru Section Wall D

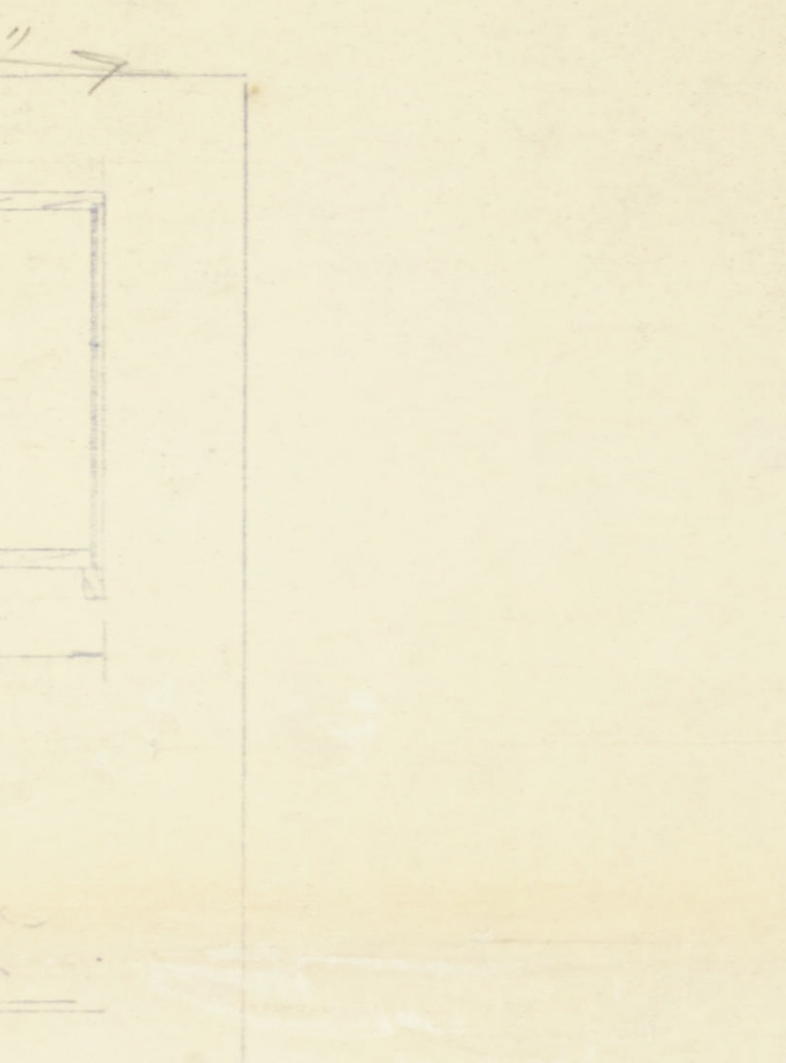

Typical Thru Section Wall D

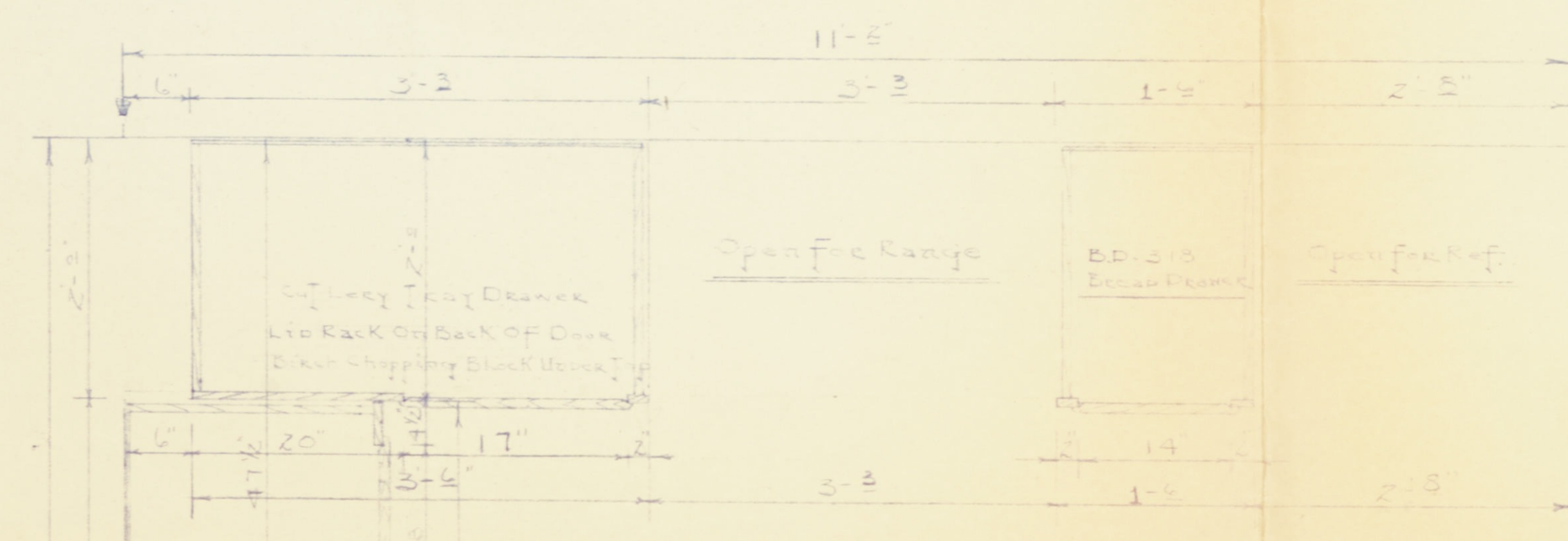

Plan of Base Cabinets

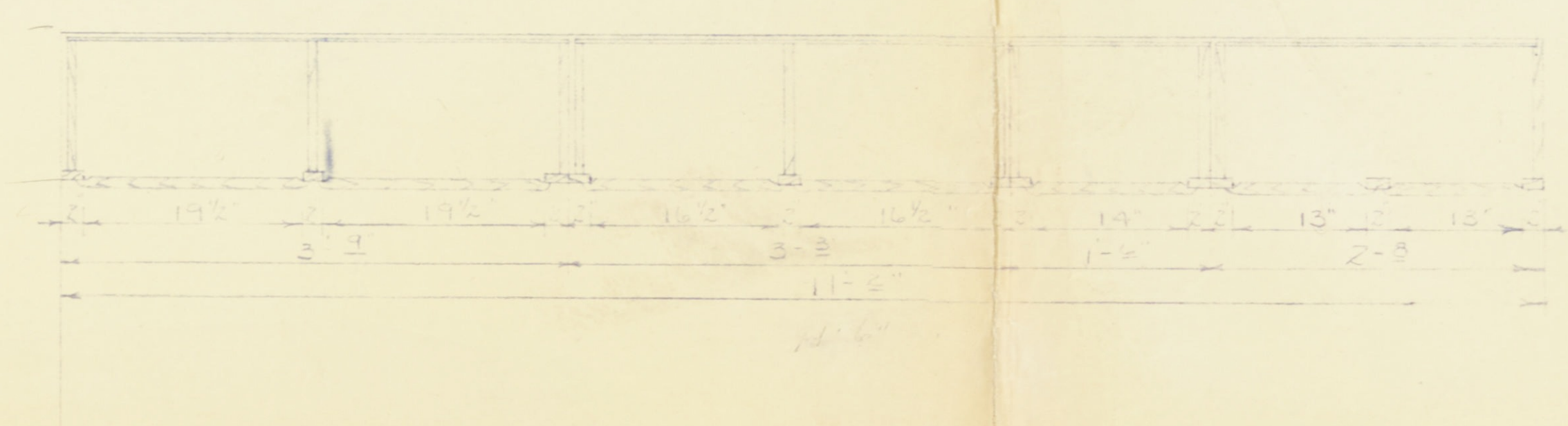

Plan Wall C



Plan Wall C

Please Note:  
 Ref. to main floor plan for location of disposal unit.  
 Hardware 3/8" offset hinges, mortise & tenon catches.  
 Chrome Drawers/Locks/Handles - Feltion Catches

SCALE: 1/4" = 1'-0"  
 KITCHEN CABS CORPORATION  
 100 N. 10TH ST. WVA  
 THE TRAPPAKOR  
 STEEL CO. - Wheeling, W. Va.  
 DRAWN BY: [Signature]  
 CHECKED BY: [Signature]  
 DATE: 1-2-54  
 SHEET: 1