

**WATER FACILITIES** Gravity and direct pressure system of water works. Water pumped from near-falling Creek into storage tanks capacity 17,000 gals. elevated 20' higher than Court House square and direct into mains by pressure force pumps capacity 300 gals per min. The Northwestern Force pump capacity 200 gals per min used as reserve. Domestic pressure mains: fire pressure mains: 10" and 8" hydrants. 2 1/2" lines of 6" to 10" mains system installed 1907.

**FIRE DEPT.** Volunteer, one chief and 6 men. Main steps at fire station (line center) 100' 2 1/2" from one corner. Also station 100' 2 1/2" from "top" of extension ladders two hand chemical extinguishers. Alarm by bell and whistles. Elevations not uniform. Streets Macadamized. Lights Elec.

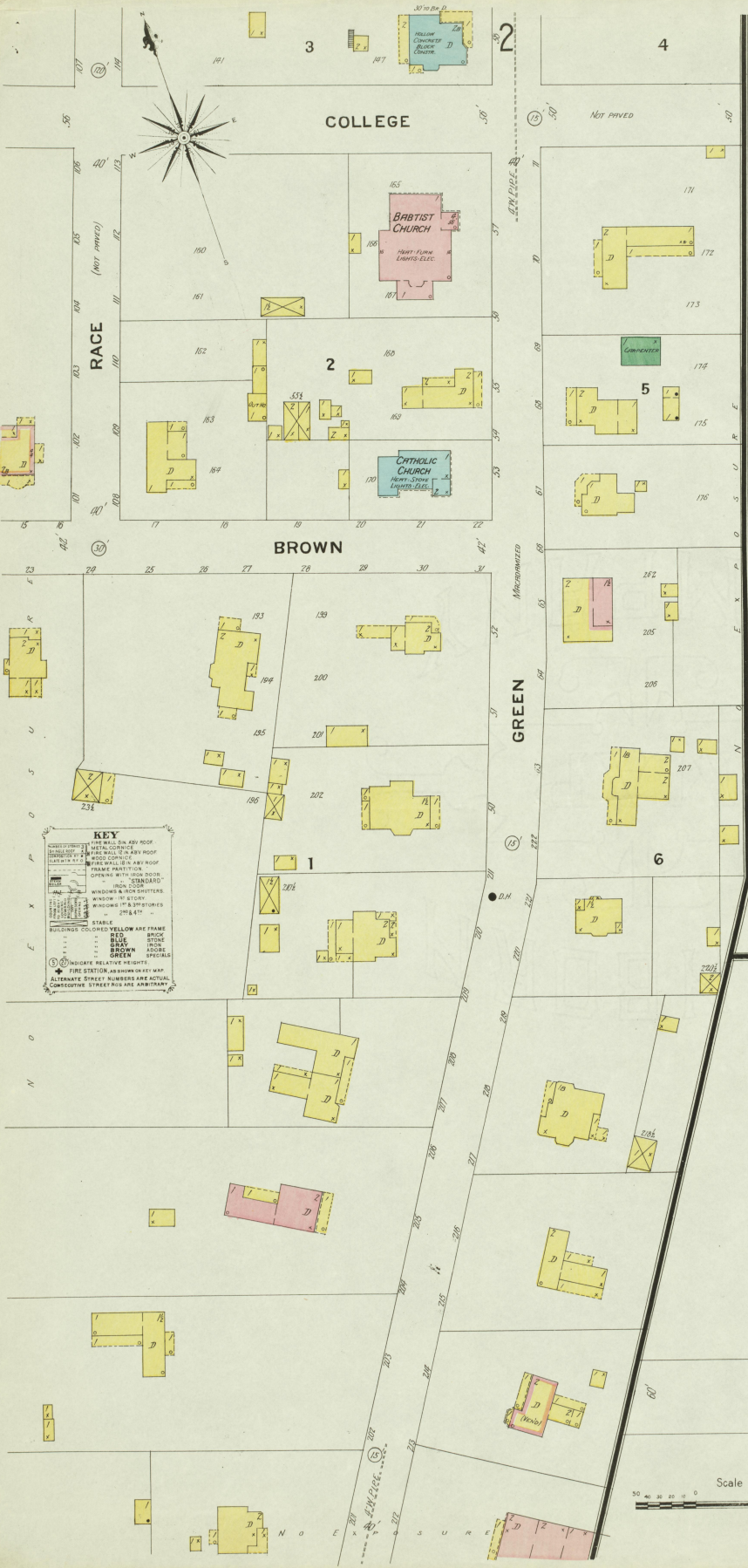

**KEY**

THE YELLOW AND ROOF  
CORRIDORS - METAL CORRUGATED  
ROOFING - FIRE WALLS - IRON  
ROOFING - IRON  
FRAME PARTITION  
OPENING WITH IRON DOOR  
STANDARD  
WINDOW - 14" STUDY  
WINDOWS IN 14" STUDIES  
20' x 41" x 10'

BUILDINGS COLORED YELLOW ARE FRAME  
RED BRICK  
BROWN STONE  
GREEN SPECIALS

INDICATE RELATIVE HEIGHTS  
FIRE STATION AS SHOWN ON KEY MAY  
ALTERNATE STREET NUMBERS ARE ACTUAL  
CONSECUTIVE STREET NUMBERS ARE ARBITRARY



**INDEX.**

STREETS.	NUMBER	STREET	NUMBER	STREET	NUMBER
Broadway	1-18	Main	101-118	Catholic Church	1
...	19-26	...	119-143	Christian Church	2
...	27-39	...	401-425	County Court House and Jail	3
...	41-59	...	...	...	...
...	101-112	...	...	...	...
Brown	1-20	Race	1-20	Davidson Bros., Warehouse	2
...	21-30	...	21-37	Law Mill	4
...	31-40	...	38-38	Open Warehouse	3
...	41-59	...	37-40	Dickey & Co., Warehouse	2
...	101-114	...	101-114	Dickinson Bros., Warehouse	2
College, Cross, see Broadway	1	Washington	101-141	Business Hotel	2
Depot	5	...	301-322	...	...
Edmondson Road	5	...	401-417	...	...
Front	5	...	401-418	...	...
...	5	...	401-425	...	...
Green	1-4	...	...	...	...
...	5-10	...	...	...	...
...	11-20	...	...	...	...
...	21-30	...	...	...	...
...	31-40	...	...	...	...
...	41-50	...	...	...	...
...	51-60	...	...	...	...
...	61-70	...	...	...	...
...	71-80	...	...	...	...
...	81-90	...	...	...	...
...	91-100	...	...	...	...
...	101-110	...	...	...	...
...	111-120	...	...	...	...
...	121-130	...	...	...	...
...	131-140	...	...	...	...
...	141-150	...	...	...	...
...	151-160	...	...	...	...
...	161-170	...	...	...	...
...	171-180	...	...	...	...
...	181-190	...	...	...	...
...	191-200	...	...	...	...
...	201-210	...	...	...	...
...	211-220	...	...	...	...
...	221-230	...	...	...	...
...	231-240	...	...	...	...
...	241-250	...	...	...	...
...	251-260	...	...	...	...
...	261-270	...	...	...	...
...	271-280	...	...	...	...
...	281-290	...	...	...	...
...	291-300	...	...	...	...
...	301-310	...	...	...	...
...	311-320	...	...	...	...
...	321-330	...	...	...	...
...	331-340	...	...	...	...
...	341-350	...	...	...	...
...	351-360	...	...	...	...
...	361-370	...	...	...	...
...	371-380	...	...	...	...
...	381-390	...	...	...	...
...	391-400	...	...	...	...
...	401-410	...	...	...	...
...	411-420	...	...	...	...
...	421-430	...	...	...	...
...	431-440	...	...	...	...
...	441-450	...	...	...	...
...	451-460	...	...	...	...
...	461-470	...	...	...	...
...	471-480	...	...	...	...
...	481-490	...	...	...	...
...	491-500	...	...	...	...
...	501-510	...	...	...	...
...	511-520	...	...	...	...
...	521-530	...	...	...	...
...	531-540	...	...	...	...
...	541-550	...	...	...	...
...	551-560	...	...	...	...
...	561-570	...	...	...	...
...	571-580	...	...	...	...
...	581-590	...	...	...	...
...	591-600	...	...	...	...
...	601-610	...	...	...	...
...	611-620	...	...	...	...
...	621-630	...	...	...	...
...	631-640	...	...	...	...
...	641-650	...	...	...	...
...	651-660	...	...	...	...
...	661-670	...	...	...	...
...	671-680	...	...	...	...
...	681-690	...	...	...	...
...	691-700	...	...	...	...
...	701-710	...	...	...	...
...	711-720	...	...	...	...
...	721-730	...	...	...	...
...	731-740	...	...	...	...
...	741-750	...	...	...	...
...	751-760	...	...	...	...
...	761-770	...	...	...	...
...	771-780	...	...	...	...
...	781-790	...	...	...	...
...	791-800	...	...	...	...
...	801-810	...	...	...	...
...	811-820	...	...	...	...
...	821-830	...	...	...	...
...	831-840	...	...	...	...
...	841-850	...	...	...	...
...	851-860	...	...	...	...
...	861-870	...	...	...	...
...	871-880	...	...	...	...
...	881-890	...	...	...	...
...	891-900	...	...	...	...
...	901-910	...	...	...	...
...	911-920	...	...	...	...
...	921-930	...	...	...	...
...	931-940	...	...	...	...
...	941-950	...	...	...	...
...	951-960	...	...	...	...
...	961-970	...	...	...	...
...	971-980	...	...	...	...
...	981-990	...	...	...	...
...	991-1000	...	...	...	...

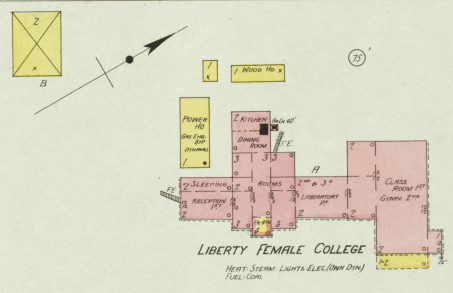

**LIBERTY FEMALE COLLEGE**  
HEAT STEAM LIGHTS ELEC. (OWN DR.)  
TEL. COM.

(NO EXPOSURE ANY SIDE)

Scale of Feet.  
0 50 100 150

Map Division  
31 JUL 1935  
Library of Congress

FEB. 1909  
GLASGOW  
KY.



Scale of Feet.

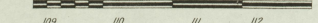

FEB. 1909  
GLASGOW  
KY.

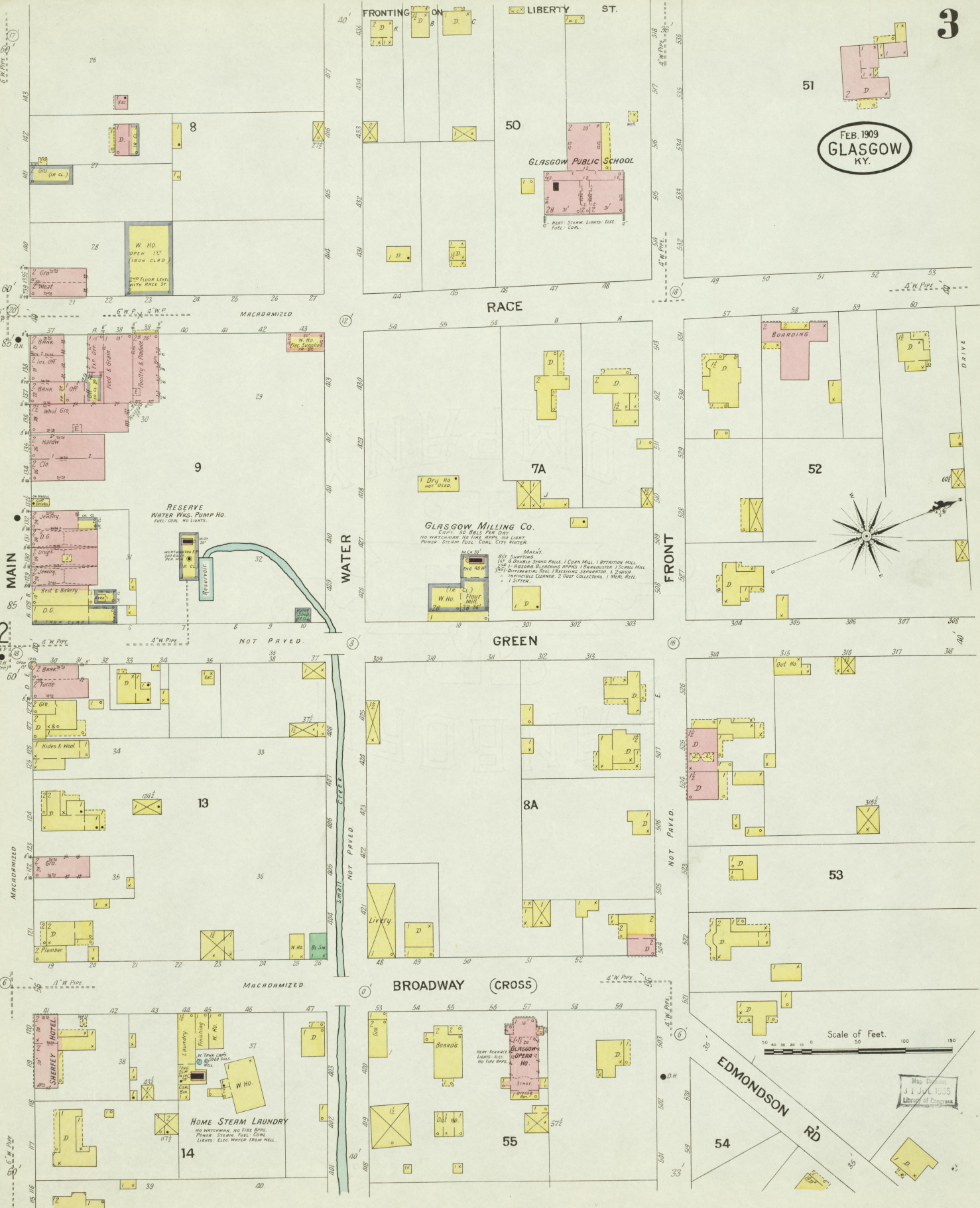

MAIN

2

MACADAMIZED

MACADAMIZED

6" W. PIPE

WATER

NOT PAVED

NOT PAVED

SMALL CREEK

RACE

GREEN

BROADWAY (CROSS)

FRONT

NOT PAVED

NOT PAVED

6" W. PIPE

EDMONDSON RD

Scale of Feet.

Map drawn  
31 JUL 1905  
Library of Congress

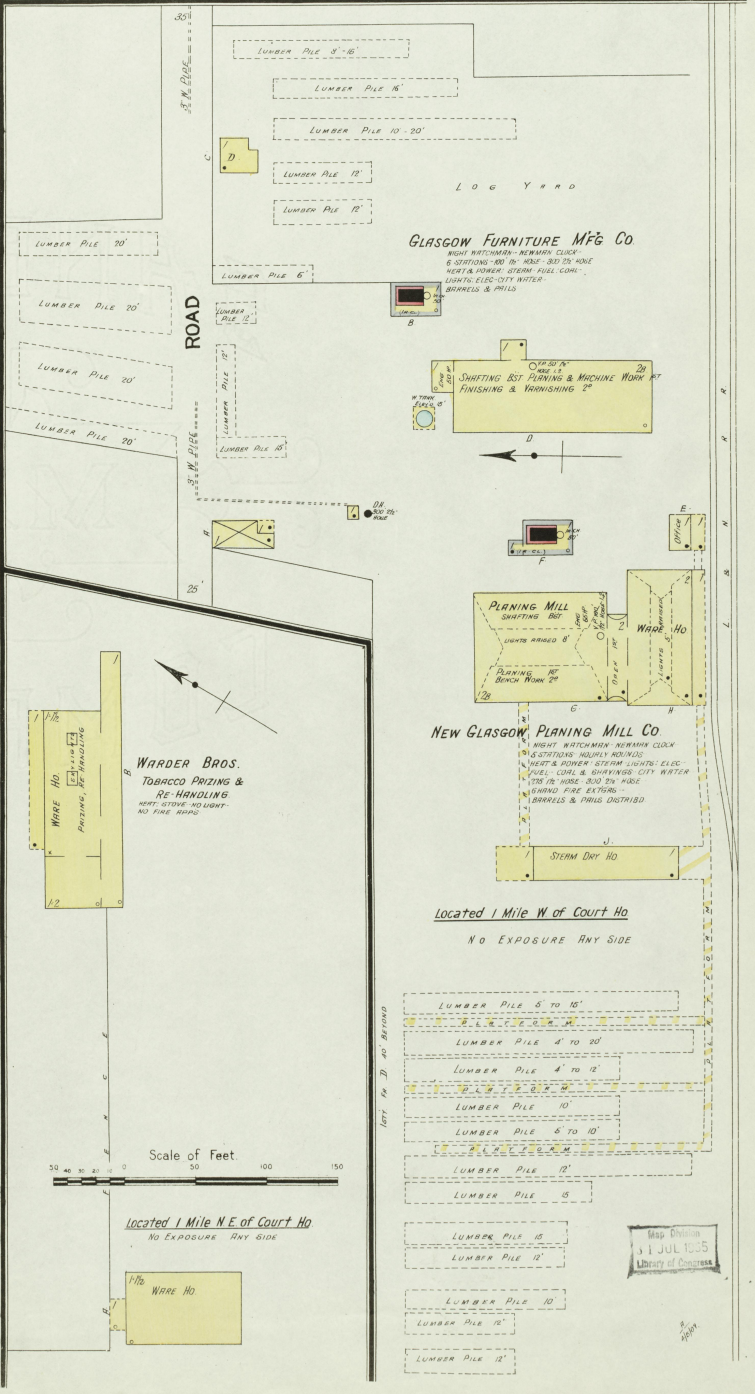
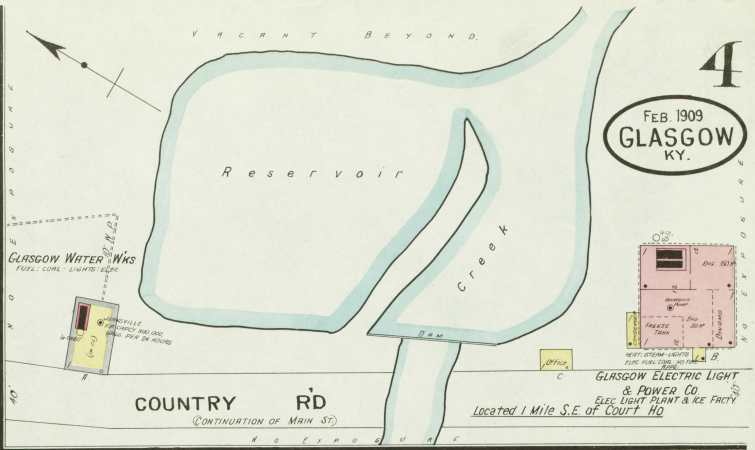
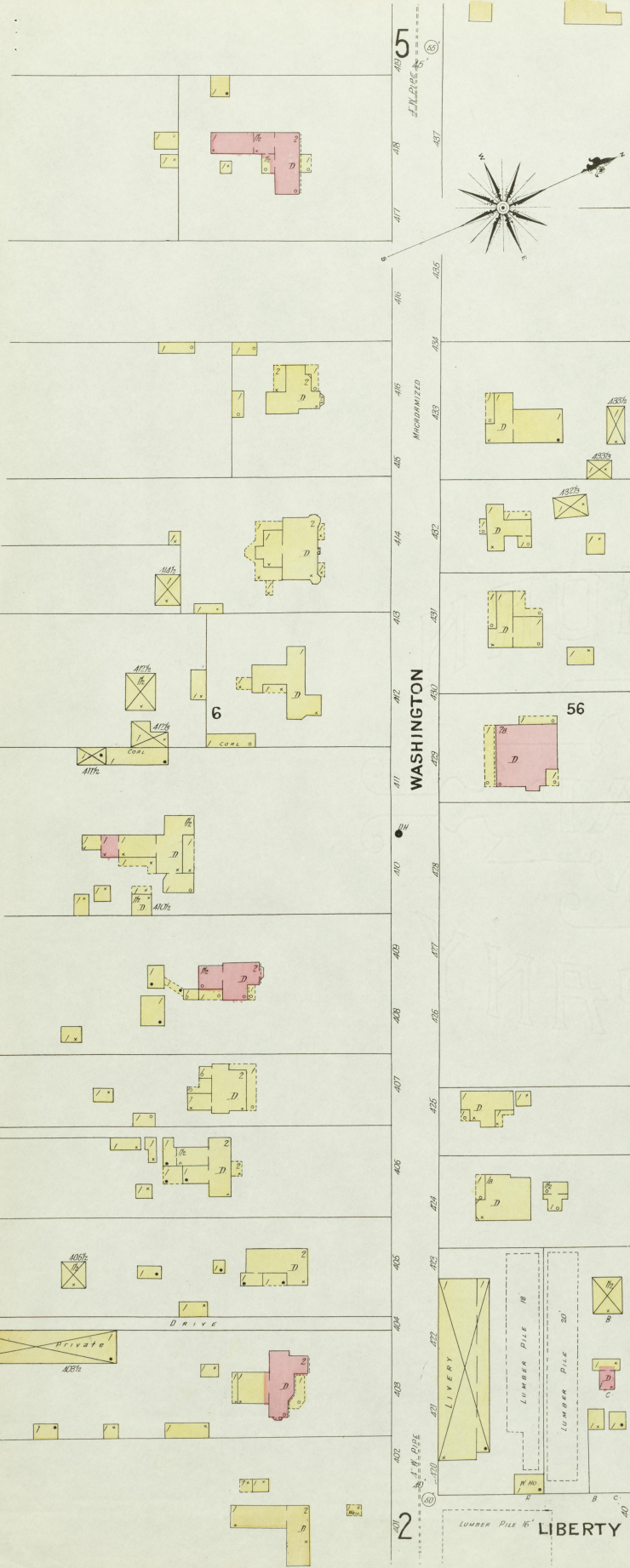

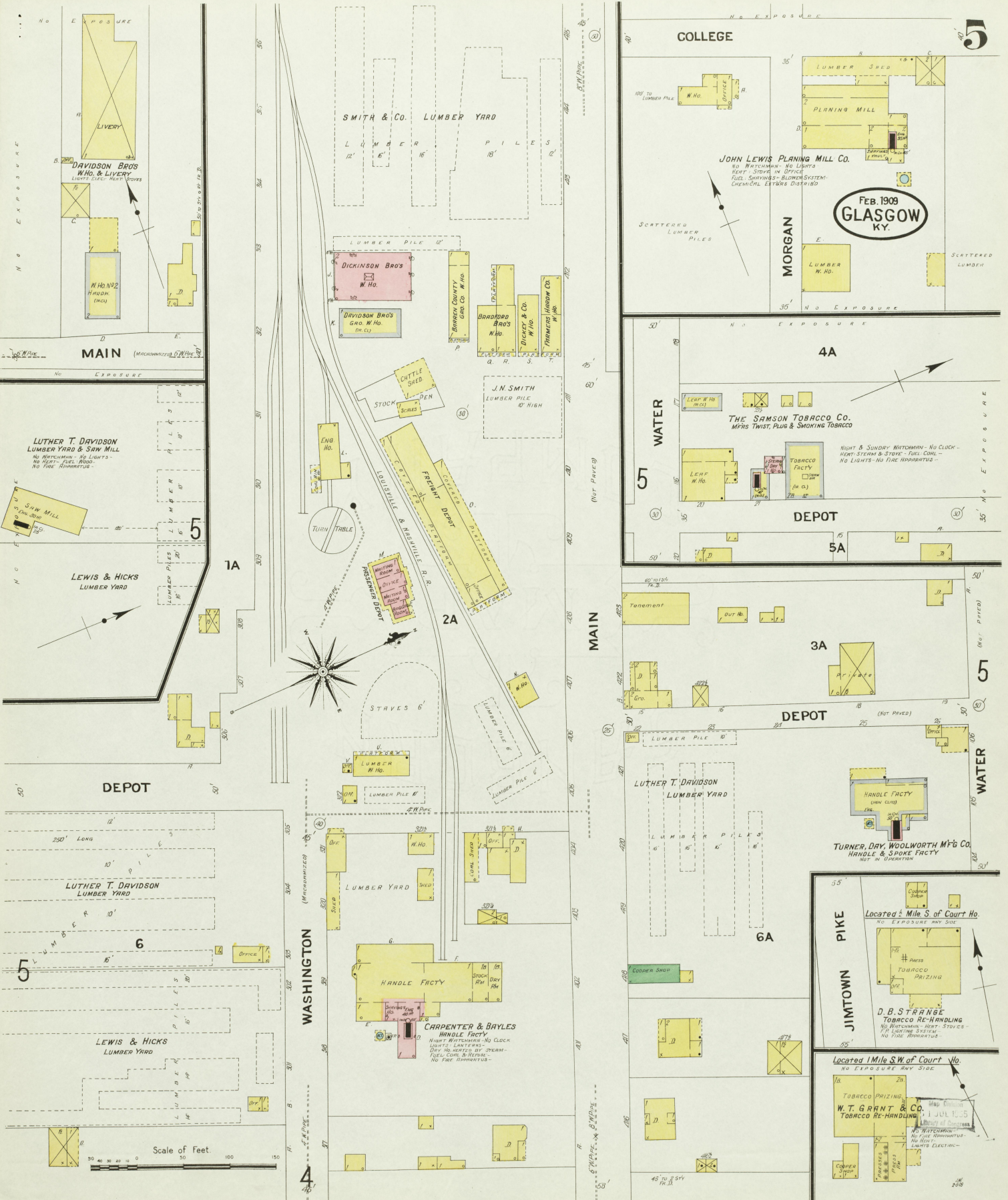

FEB. 1908  
GLASGOW  
KY.

Located 1/2 Mile S. of Court Ho.  
NO EXPOSURE ANY SIDE

Located 1 Mile S.W. of Court Ho.  
NO EXPOSURE ANY SIDE

**W.T. GRANT & CO.**  
TOBACCO PRIZING  
TOBACCO RE-HANDLING  
LIBRARY OF B.C.A.  
JUL 10 1905  
NO WATCHMAN - HEAT - STOVES  
NO FUEL - REHANDLING  
NO MATCHES - NO LIGHTS  
ELECTRIC

**D.B. STRANGE**  
TOBACCO RE-HANDLING  
NO WATCHMAN - HEAT - STOVES  
NO FUEL - REHANDLING  
NO MATCHES - NO LIGHTS

**TURNER, DRY, WOOLWORTH MFG CO.**  
HANDLE & SPOKE FACTRY  
NOT IN OPERATION

**HANDLE FACTY**  
(now closed)

**THE SAMSON TOBACCO CO.**  
MFRS TWIST, PLUG & SMOKING TOBACCO  
NIGHT & SUNDAY WATCHMAN - NO CLOCK  
HEAT - STEAM & STOVE - FUEL COAL -  
NO LIGHTS - NO FIRE APPARATUS

**DEPOT**

**LUTHER T. DAVIDSON LUMBER YARD**

**LUTHER T. DAVIDSON LUMBER YARD**

**D.B. STRANGE TOBACCO RE-HANDLING**

**W.T. GRANT & CO. TOBACCO PRIZING**

**TURNER, DRY, WOOLWORTH MFG CO. HANDLE & SPOKE FACTRY**

**DEPOT**

**DEPOT**

**THE SAMSON TOBACCO CO.**

**JOHN LEWIS PLANING MILL CO.**

**COLLEGE**

**DAVIDSON BROS WHO. & LIVERY**

**LUTHER T. DAVIDSON LUMBER YARD & SAW MILL**

**LUTHER T. DAVIDSON LUMBER YARD**

**LUTHER T. DAVIDSON LUMBER YARD**

**LEWIS & HICKS LUMBER YARD**

**LUTHER T. DAVIDSON LUMBER YARD**

**DEPOT**

**DEPOT**

**MAIN**

**DAVIDSON BROS WHO. & LIVERY**